

264 West 35th Street

Between 7th & 8th Avenue, MIDTOWN WEST



SIZE

750SF - Ground Floor
200SF - Mezzanine

ASKING RENT

Upon Request

POSSESSION

Immediate

CURRENTLY

Vacant

FRONTAGE

12 Feet

CEILING HEIGHT

18 Feet

NEIGHBORS

Staples, McDonald's, Duane Reade, Starbucks, Essen', Party City, Taco Bell Cantina, Houndstooth Pub, DSW, Gregory's Coffee

TRANSPORTATION

34th Street - Penn Station



34th Street - Subway Extension



LOCATION

Located steps from:

- Penn Station
- Madison Square Garden
- Moynihan Station
- Hudson Yards

Contact Exclusive Agent:

Adam Goldschmidt
adam@goldcorealty.com
917.902.1154



BETWEEN 7th & 8th Avenue, MIDTOWN WEST

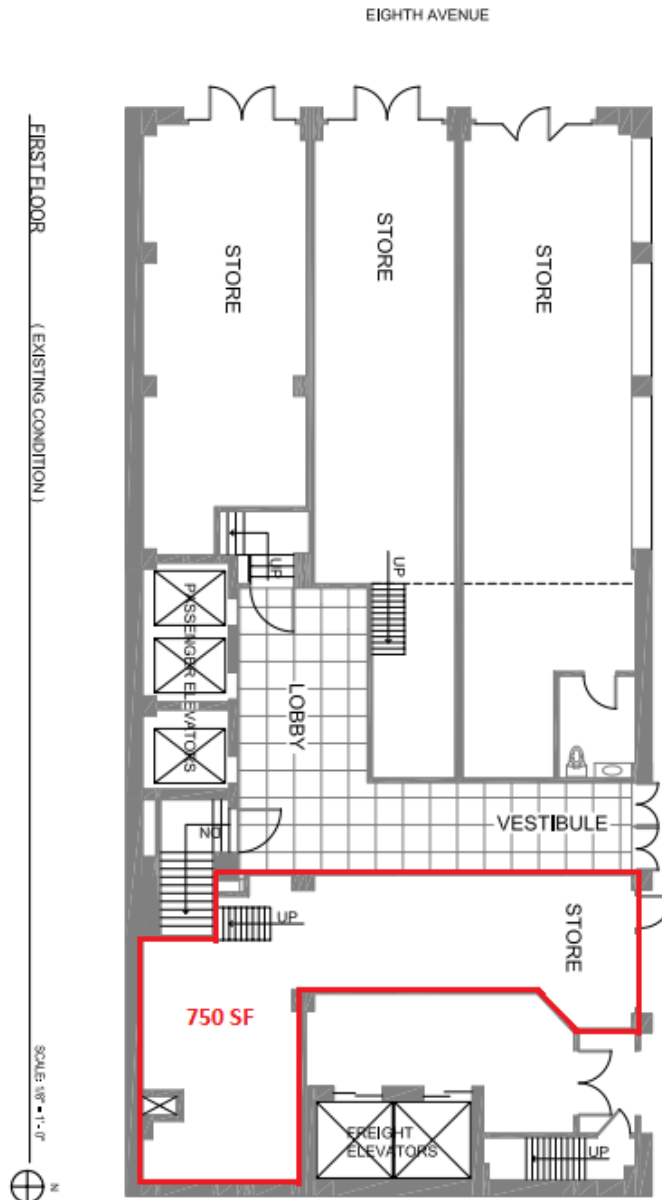

**GOLDCO
REALTY**